

# ACTILINK *Reborn* Installation Manual

## 1 Location

Place the product in a flat, untilted location with minimum 5 Cm distance in each direction.

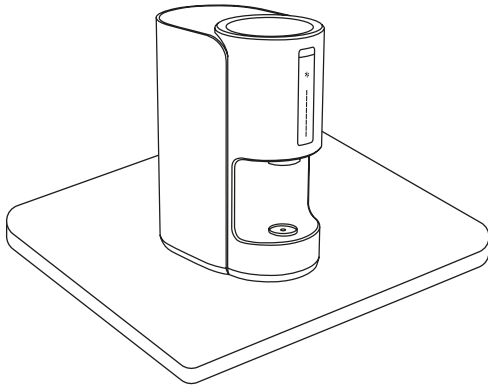

## 2 Connect the power cable and adapter with the power socket

Put the power on using the power button in the backside of the unit.

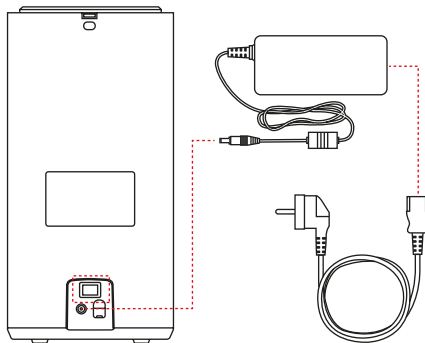

## 3 Check the LED and warming up operation

Make sure the yellow LED in the front of the unit is on. Run 2~3 cycle with no load for warming up the unit by pressing the Start button in the front if it is installed for the first time or not used for a long time.

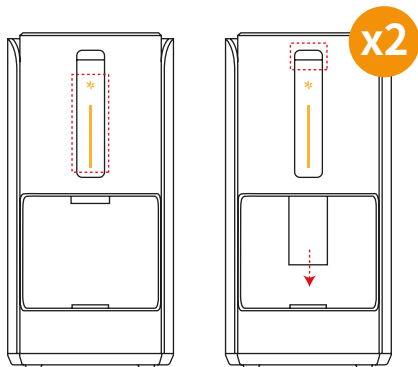

## 6 Proceed activation

Now the unit is ready to activate target products using the proper holders.

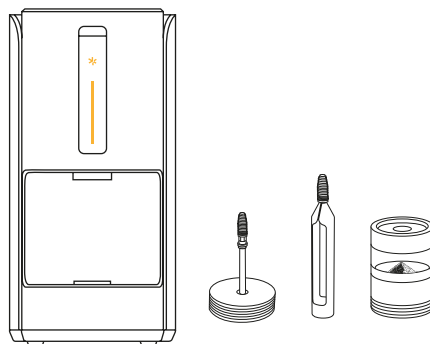

# ACTILINK *Reborn* Installation Manual

## ■ Check list for the Actilink Reborn installation

NO.	Check point	Result	
		Yes	No
1	Does the yellow LED lit when the power is on?	<input type="checkbox"/>	<input type="checkbox"/>
2	Have you made the warming up cycle with no load for 2~3 times?	<input type="checkbox"/>	<input type="checkbox"/>
3	Does the Start button in the front of unit work properly without trapping?	<input type="checkbox"/>	<input type="checkbox"/>
4	Do the genuine holders stick to the mount by magnet properly?	<input type="checkbox"/>	<input type="checkbox"/>
5	Is there any interference between the pipe and holders during operation?	<input type="checkbox"/>	<input type="checkbox"/>

- ※ Object material and holders must be dry for proper activation because this unit is using plasma technology in vacuumed environment. Excessive moisture during operation may damage the product, so be careful.
- ※ The manufacturer will not take responsibility for any malfunction or wrong performance of the unit if not-regulated object or holder is used for operation.

If the tube goes up before finishing the activation: To protect this device, the tube will immediately go up automatically if any mechanical interference or excessive moisture is sensed during operation. Normal operation will be resumed by pressing the Start button after removing any obstacle or moisture on the objects.

Emergency stop: Anytime during operation, an emergency stop can be made by pushing the Start button for 3 seconds. Red LED will blink, and the unit will get back to the stand-by mode for resuming operation.

Sudden power-off during operation: Check connection of the power cables. Make sure the power button is on. Power plug needs to be earthed for safe operation.

※ Consult with local C/S center or distributor if the same problem occurs repeatedly.

Company Name

Contact Number

E-mail

S/N

Date

Installer (signature)

Customer (signature)